

**CONCEPTUAL GRADING DESIGN  
FOR  
REGIONAL GATEWAY COMMERCE PARK  
I-10 & I-8 INTERCHANGE  
CASA GRANDE, AZ**

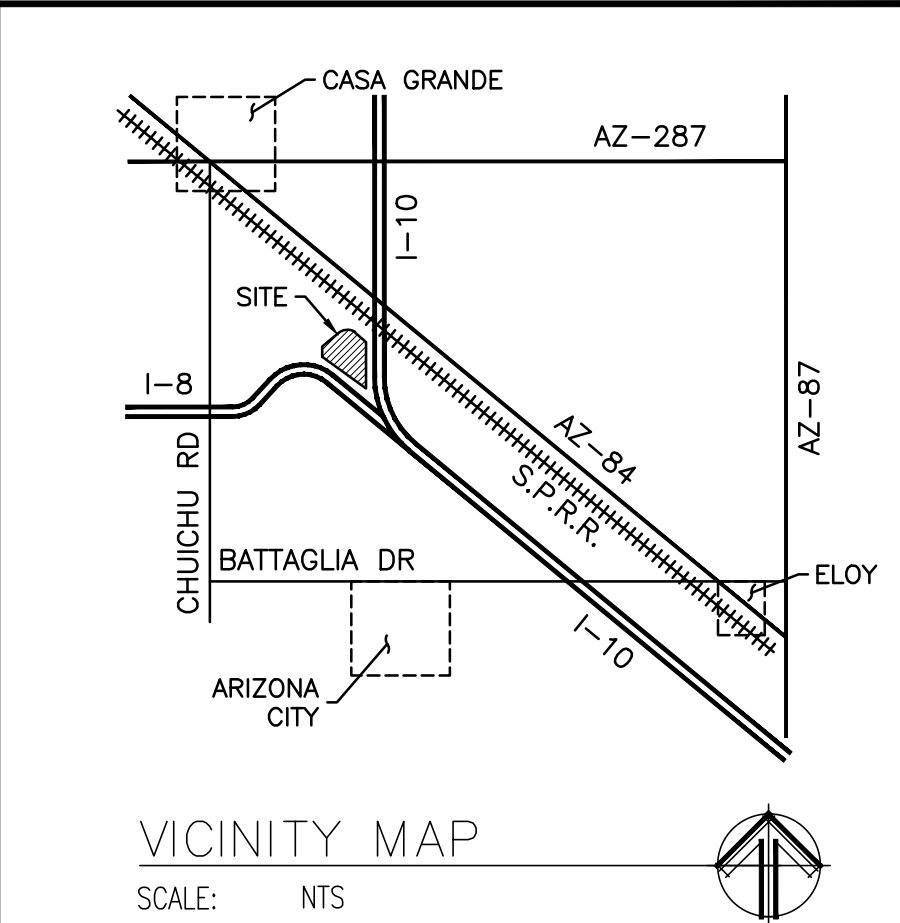

**NOTES:**

- ALL LOTS WITHIN THE COMMERCE PARK, WITH THE EXCEPTION OF THE CORPORATE OFFICE LOTS, ARE TO RETAIN THEIR GROSS AREA PORTION OF THE 100-YEAR, 2-HOUR STORM EVENT.
- THE OPEN SPACE AREA WILL RETAIN THE CORPORATE OFFICE LOTS' GROSS AREA RETENTION VOLUME.

**DEVELOPER**  
CHASSE R.E. & FINANCIAL GROUP  
P.O. BOX 15267  
PHOENIX, AZ 85060  
CONTACT: GEORGE CHASSE, SR.

**ENGINEER**  
CEG, INC.  
P.O. BOX 2368  
GLENDALE, AZ 85311  
623.536.1993  
CONTACT: NATE COTTRELL

**REGIONAL GATEWAY COMMERCE PARK  
CONCEPTUAL GRADING DESIGN**

I-10 & I-8 INTERCHANGE  
CASA GRANDE, AZ

DRAWN BY: NEB  
CHECKED BY: NJC  
DATE: 06/21/13  
SCALE: 1" = 300'  
PROJECT #: 12-121  
LAST MODIFIED: \_\_\_\_\_  
LAST MODIFIED BY: \_\_\_\_\_

**P.O. BOX 2368  
GLENDALE, AZ 85311  
PH: (623) 536-1993**

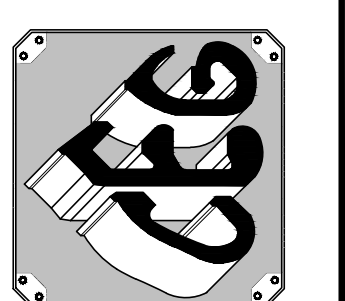

SHEET 1 OF 1  
**C0.01**

EXHIBIT 10

CASA GRANDE MTN. RANCH 12-121 CITY#